

## Changing the Handing of the lockcase

1. Remove the 2 faceplate screws (X) using a T20 Torx bit (see fig.1). Please note, for 70mm backset locks remove the screws nearest to the faceplate.
2. Carefully remove the faceplate.
3. Rotate the latch and, if fitted, the anti-thrust latch (see fig.2)
4. Replace the faceplate ensuring the latch and bolts operate freely.
5. Refit the Torx head screws.

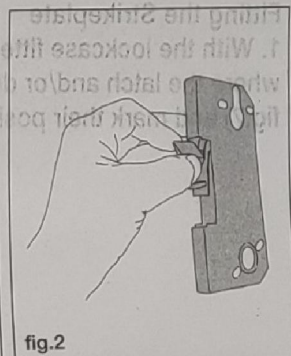
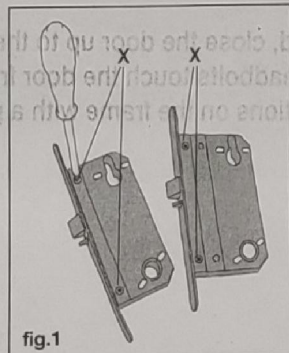

## Preparing the Door

1. Using a pencil, mark

- [a] the centreline of the door on the door edge
- [b] the required height of the lever spindle position on both door faces, or in the case of a deadlock the height of the cylinder centreline (see fig.3)

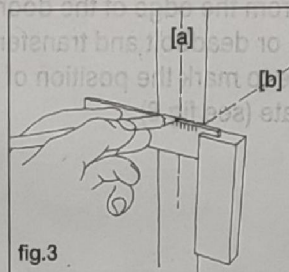

2. Hold the lockcase in position up against the door edge and carefully trace around it. see fig.4. Please ensure you align to the cylinder centreline or the lever spindle position as marked in 1 above.

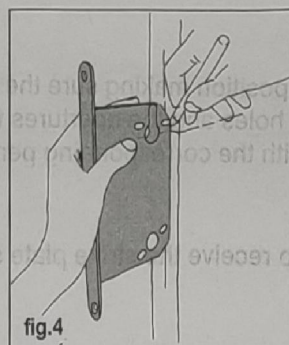

3. Mortice out the door to accept the lock case making sure the lock case inserts into the door freely but ensuring there is minimal movement of the lock in the door.

4. With the lock case placed in the door mark around the forend (see fig.5) and recess the door so that the lock forend lies flush with the edge of the door (remove the lock case from the door before proceeding).

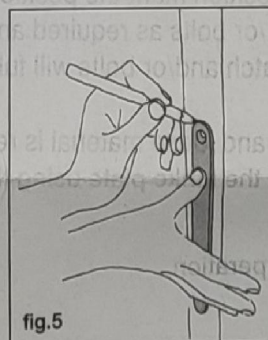

5. Use the template provided to mark the door faces for the lever handle and/or cylinder holes as required. Cut or fold the template as shown and hold in place on the door making sure that:

- a. the template is in the correct orientation
- b. you are using the correct template for 50mm or 70mm backset locks
- c. the lines marked **door edge** and **lever or cylinder centreline** are correctly aligned with the pencil marks on the door

6. With the template held in position mark all the drill centres (see fig.6) and repeat on the other door face.

IT IS ESSENTIAL TO ENSURE YOU MARK ONLY THE DRILL POSITIONS REQUIRED TO SUIT THE LOCK BEING FITTED.

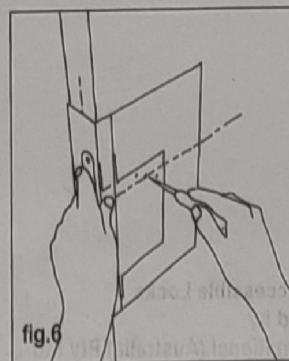

7. Make the drill holes as indicated on the template according to the lockcase style and remove all loose chippings and debris.

8. Check the drillings are accurate and match the lockcase type.

9. Insert the lock and fix using the screws provided.

10. Continue to fix the cylinder and other hardware as required.



# Accessible Lock

## Installation Instructions and Template

### Fitting the Strikeplate

1. With the lockcase fitted, close the door up to the point where the latch and/or deadbolts touch the door frame. (see fig.7) and mark their positions on the frame with a pencil.

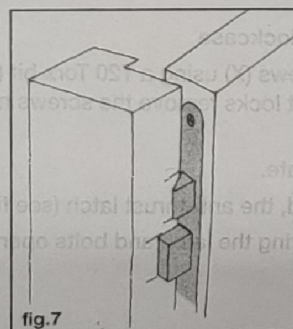

2. Measure the distance from the edge of the door to the centreline of the latch or deadbolt and transfer this measurement to the frame to mark the position of the centreline of the strike plate (see fig.8).

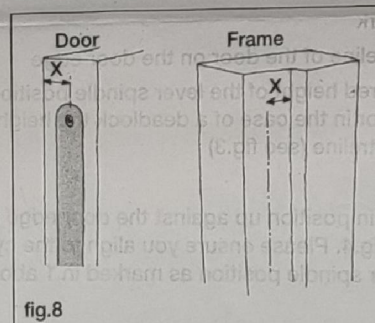

3. Hold the strikeplate in position making sure the centreline is visible through the fixing holes and the apertures for the latch and/or bolts are in line with the corresponding pencil marks on the frame. (see fig.9)

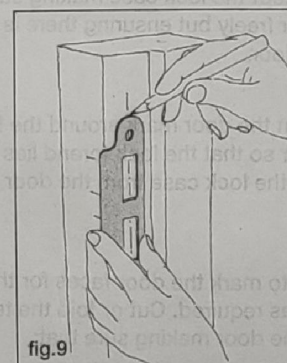

4. Mortice out the door to receive the strike plate so that it is flush with the frame.

5. With the strikeplate in position mark the position of the apertures for the latch and/or bolts as required and mortice out to a depth where the latch and/or bolts will fully extend.

6. Make sure all chippings and loose material is removed from the mortices and refit the strike plate using the screws provided.

7. Close door and check operation.



Securefast Accessible Locks  
manufactured by  
Chengs International (Australia) Pty Ltd  
PO Box 1266 Glen Waverley 3150 Victoria Australia  
1121 CPD AG0027